

abbotFox  
Bespoke.



Taverham Road, Felthorpe, Norwich  
*Guide Price £575,000*

“

abbotFox Bespoke is a private office within abbotFox specialising in the sale and letting of some of the region's most exclusive and prestigious properties.

Samuel Le Good | **Head of Bespoke**







## THE DETAIL \_\_\_\_\_

abbotFox Bespoke presents this exceptional opportunity to acquire a home offering the perfect blend of rural tranquillity and convenient access to Norwich.

Occupying a generous plot, backing fields, this home offers a lifestyle that embraces space, privacy, and versatility. Behind its modest frontage lies a beautifully presented and thoughtfully extended home, with flexible accommodation ideal for any buyer looking to enjoy life on one level.

The heart of the property is the open-plan kitchen and family area—flooded with natural light and opening onto the rear garden, it's a space designed for modern living and effortless entertaining. A separate sitting room offers a quiet retreat, while additional reception space ensures this home can adapt to a range of needs. The property also boasts a single garage, suitable for parking a car or additional storage.

Located within easy reach of Norwich, with excellent road links and access to local schools and amenities, this is a rare chance to enjoy countryside living without compromise.

Early viewing is highly recommended.

Guide Price £575,000 - £600,000







## THE HIGHLIGHTS \_\_\_\_\_

- Extended detached bungalow
- Backing open fields
- Exceptional living accommodation
- Four bedrooms
- Generous plot
- Popular village location
- Guide price £575,000 - £600,000
- Single garage

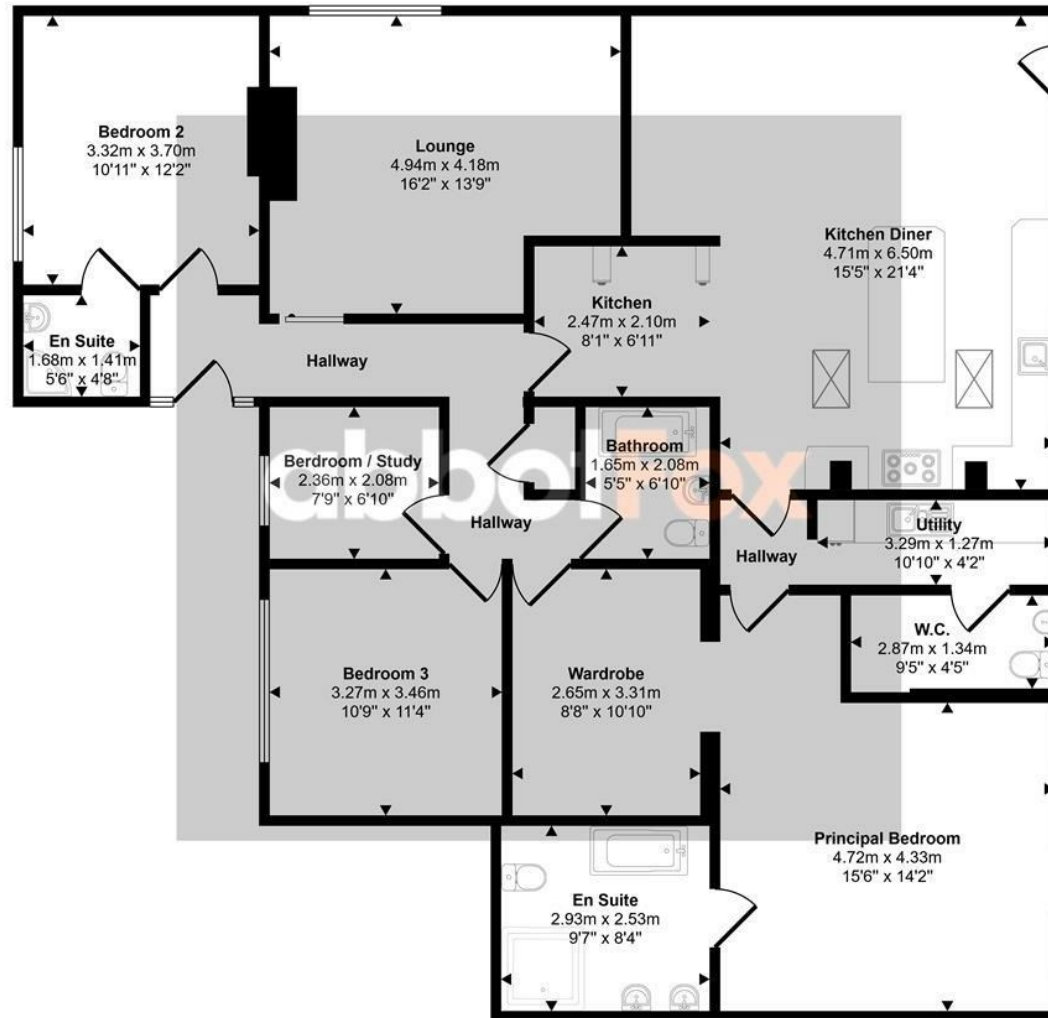

Floorplan

*Let's talk*

01603 660000

sales@abbotfox.co.uk

@abbotfox @abbotfoxbespoke

EPC RATING -

Disclaimer – In accordance with the Property Misdescriptions Act, the company abbotFox gives notice that all descriptions, references to condition, necessary permissions for use and other details are given in good faith and believed to be correct, but any purchaser should not rely on them as statements of fact, and must satisfy themselves by inspection or other means, as to their accuracy.